

TOYOTA HILUX REVO POWER BOARD

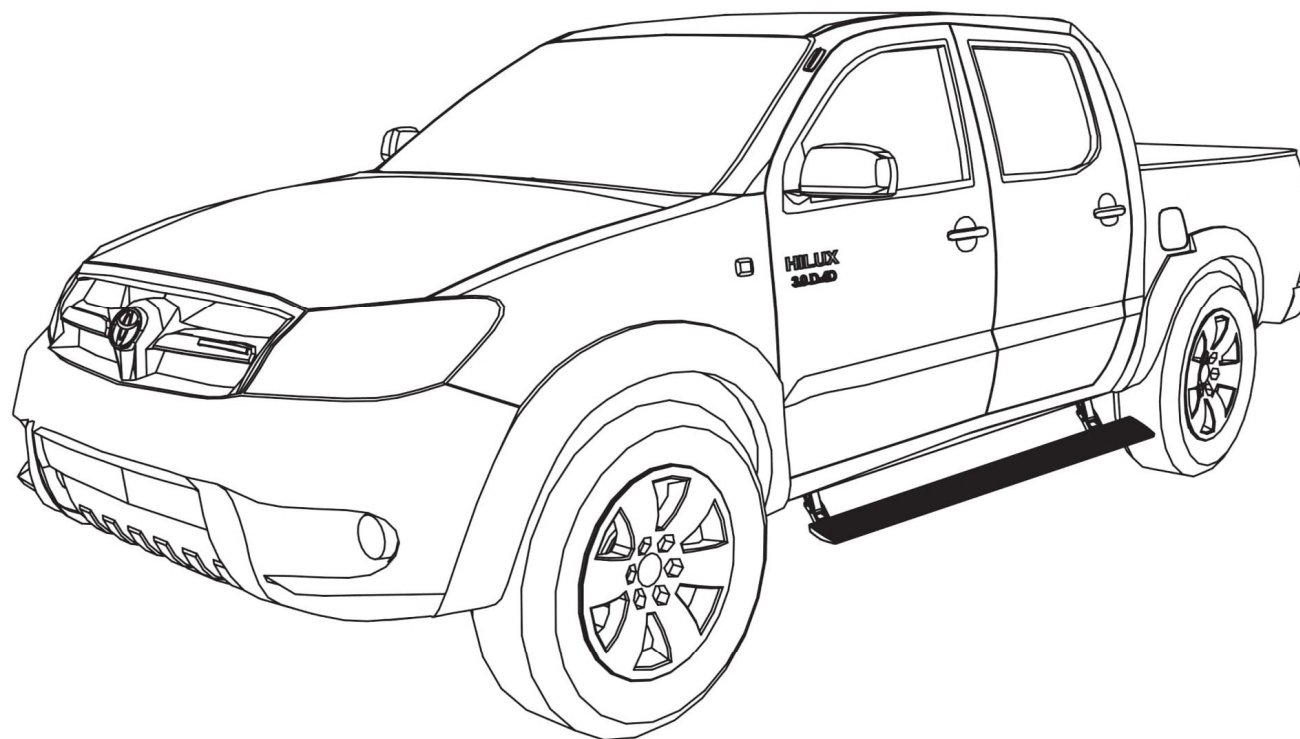

APPLICATION: Toyota Hilux Revo 2015



INSTALLATION GUIDE

INSTALLATION TIME

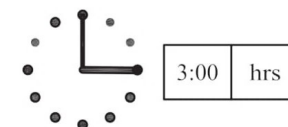

SKILL LEVEL



4=Experienced

PART: PST05-1110
PST05-1130

TOOLS REQUIRED:

- ① 5 mm hex key wrench (allen wrench)
- ② 13mm socket
- ③ Pry
- ④ Wire stripper/cutter
- ⑤ Vinyl tape
- ⑥ Screwdriver

Contents

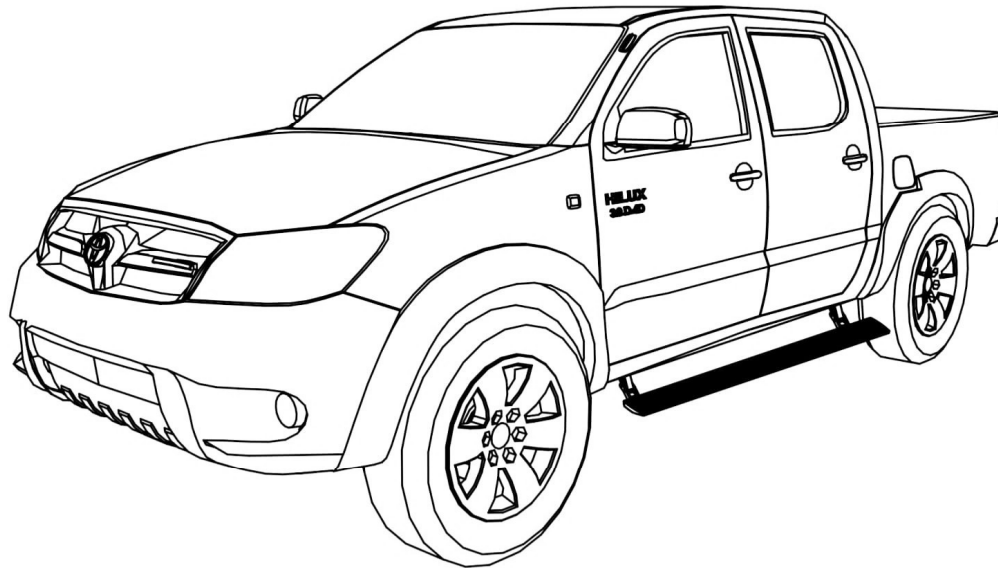

Product Technical Specification.....	02
Product Packing List	03
Mechanical Installation.....	07
Electrical Installation.....	10
Maintenance.....	16
Warranty Card	17

Product Technical Specifications

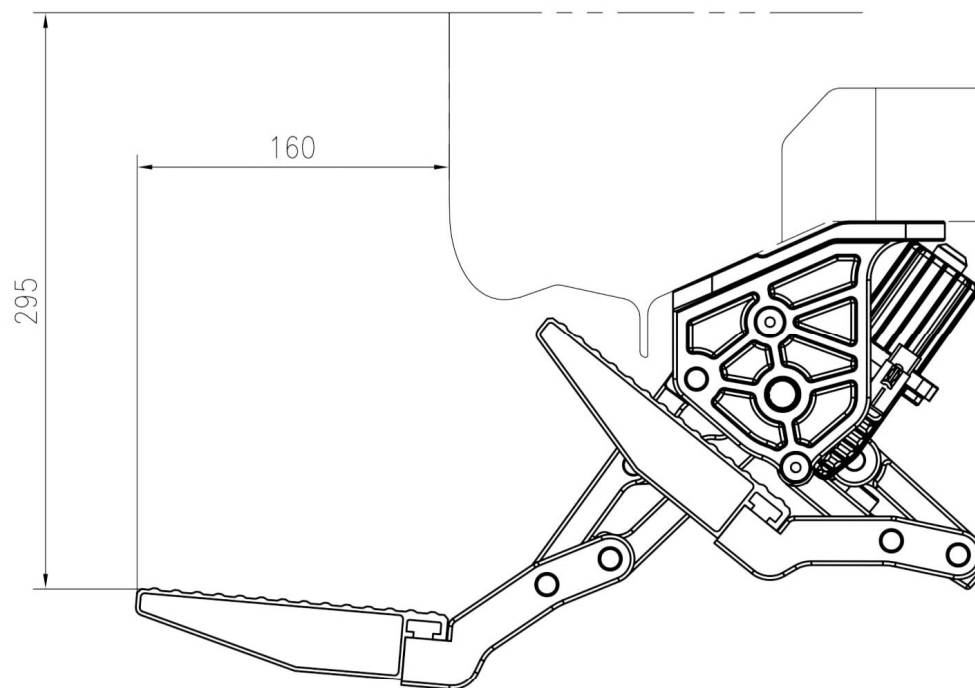

Rated voltage: 12V

Rated load: $\leq 300\text{kg}$

Length: 1.63m

Gross weight: 23kg

Forward extension size: 160mm

(Horizontal distance between the edge of power board and the vehicle door when the step extends)

Step falling dimension: 295mm

(Vertical height difference between the edge of power board and the vehicle door while step extending.)

(Both dimensions of forward and falling are theoretical, which may vary due to uncertainties such as installation error, manufacturing errors of vehicle bottom and etc.)

Note: Impact load is not allowed.

Please make sure the children and the aged will keep 25cm safe distance while power board is working to avoid any bumped or jammed.

Product Packing List

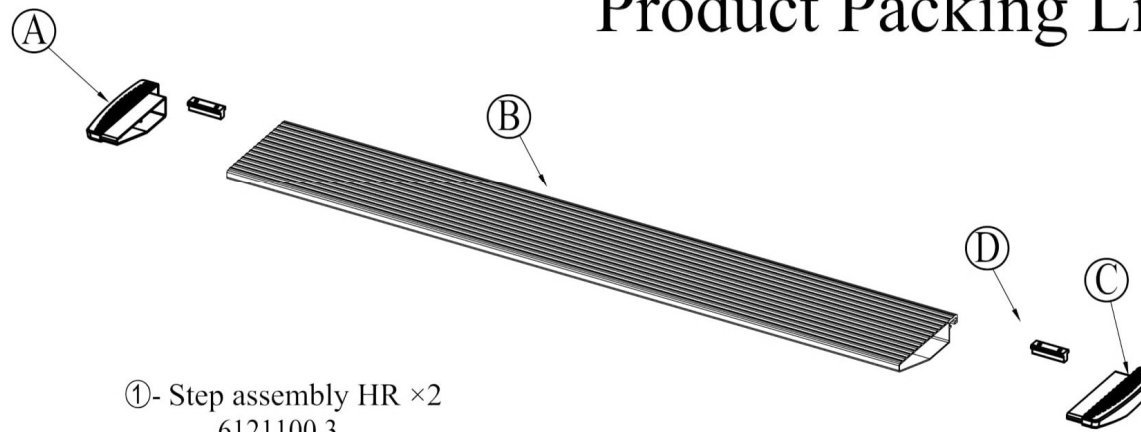

(A) 6126100.3-4	End cap left B	(×1)
(B) 6121100.2-1	Step HR	(×1)
(C) 6126100.3-1	End cap right B	(×1)
(D) 6126100.3-3	T-nut	(×2)

①- Step assembly HR ×2
6121100.3

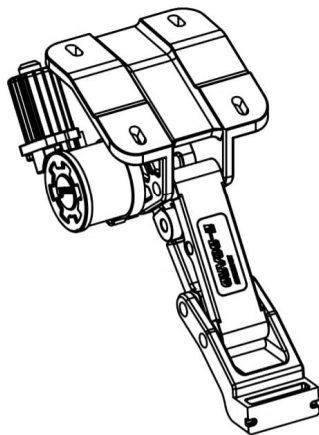

②-Front Motor Linkage Right HR-L×1
6121100.1L

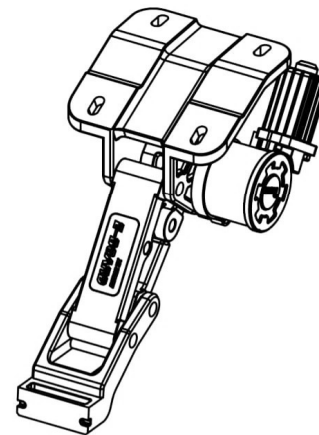

③-Front Motor Linkage Left HR-R×1
6121100.1R

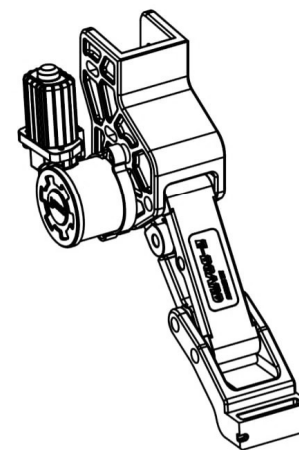

④-Rear Motor Linkage Left HR-L×1
6121100.2L

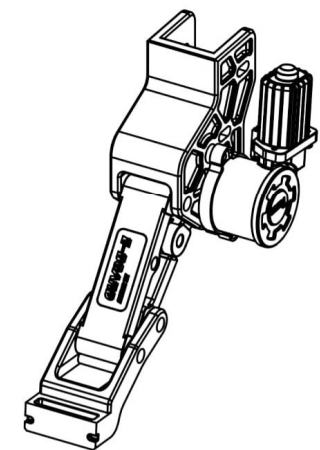

⑤-Rear Motor Linkage Right HR-R×1
6121100.2R

TOYOTA HILUX REVO

E-BOARD®

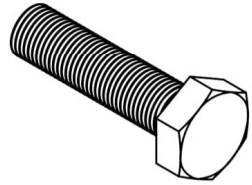

⑥- Full thread (coarse)
hexagon head bolt ×6
GB/T5783-2000 M8×30

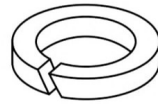

⑦-Spring washer ×8
GB/T93-1987 8

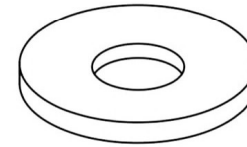

⑧-Flat washer grade A ×8
GB/T96.1-2000 8



⑨ -Hex nut ×2
GB/T6170-2000 M8



⑩-Socket Cap Bolt ×8
GB/T70.1-2000 M6×20

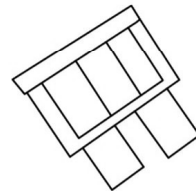

⑪-25A fuse ×2

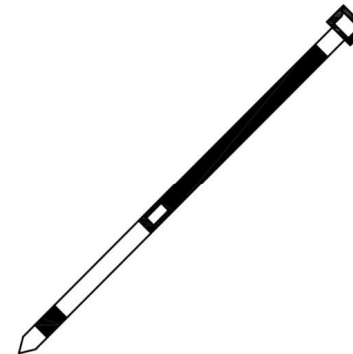

⑫-Cable tie ×25
GB/T22344-2008 5×300

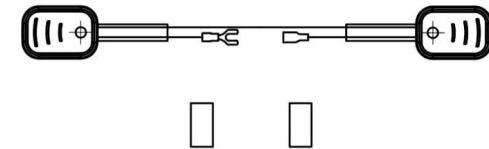

⑬-Magnetic inductor ×2
Magnet×4

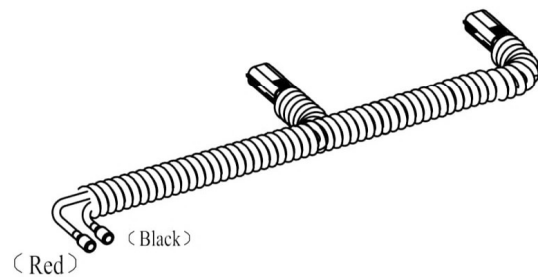

⑭ -Motor connection wire HR×2
6121100.4.3

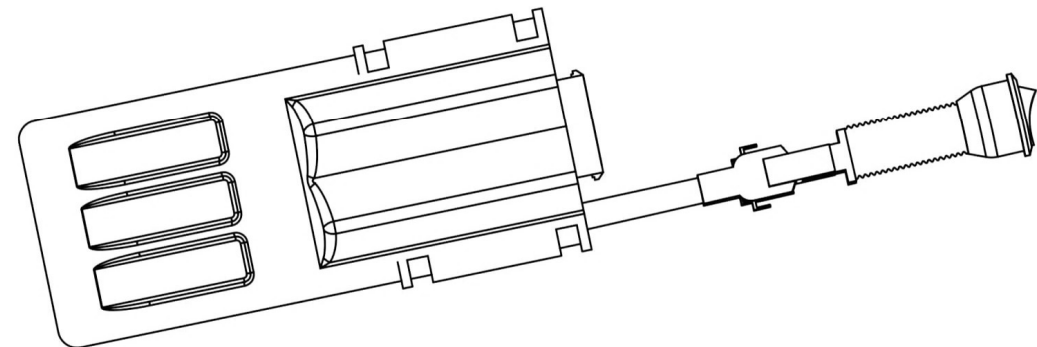

⑮ -Controller assembly HR×1
6121100.4.6

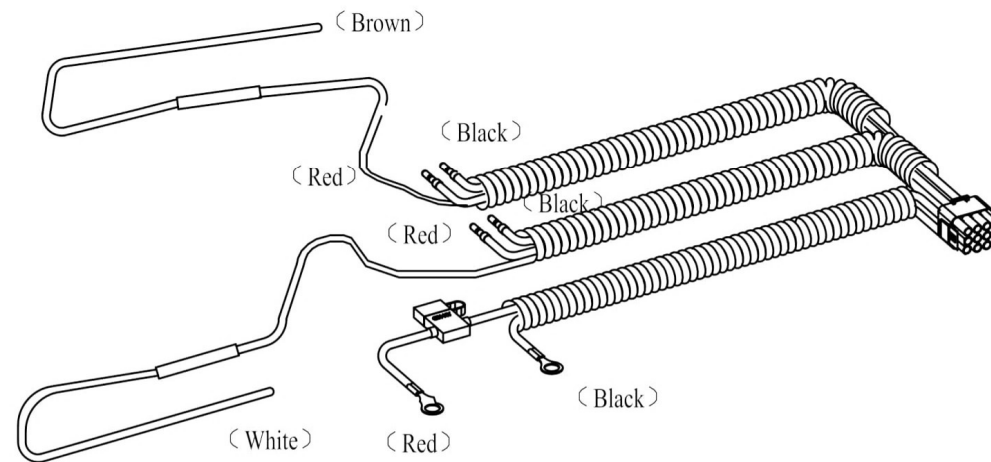

⑯ -Control input wire HR×1
6121100.4.1

Mechanical Installation

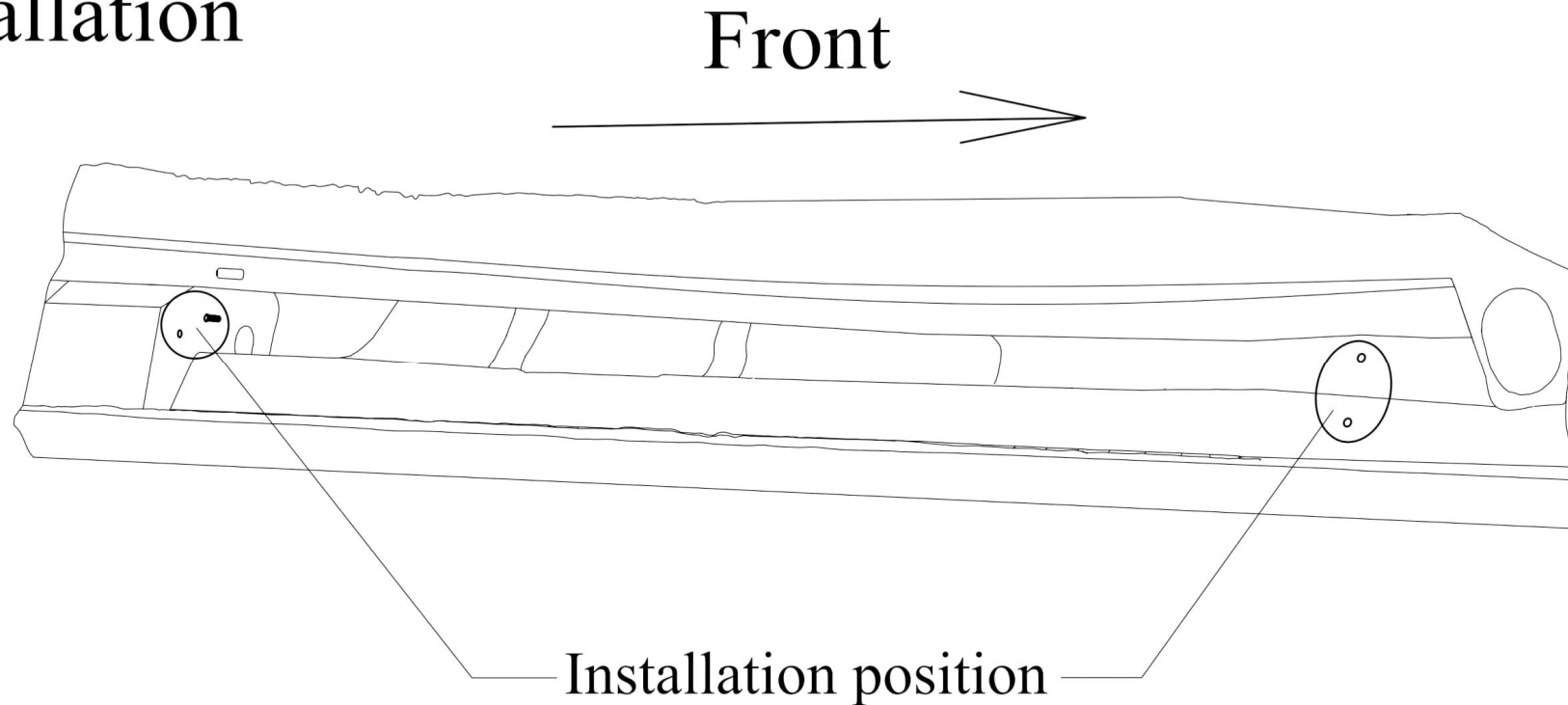

Installation position
on the Left

As shown in the picture: The installation hole of motor linkage should be match vehicle original step fixing hole.

- ⑧ Φ8 Flat washer
- ⑦ Φ8 Spring washer
- ⑨ M8 Hex nut

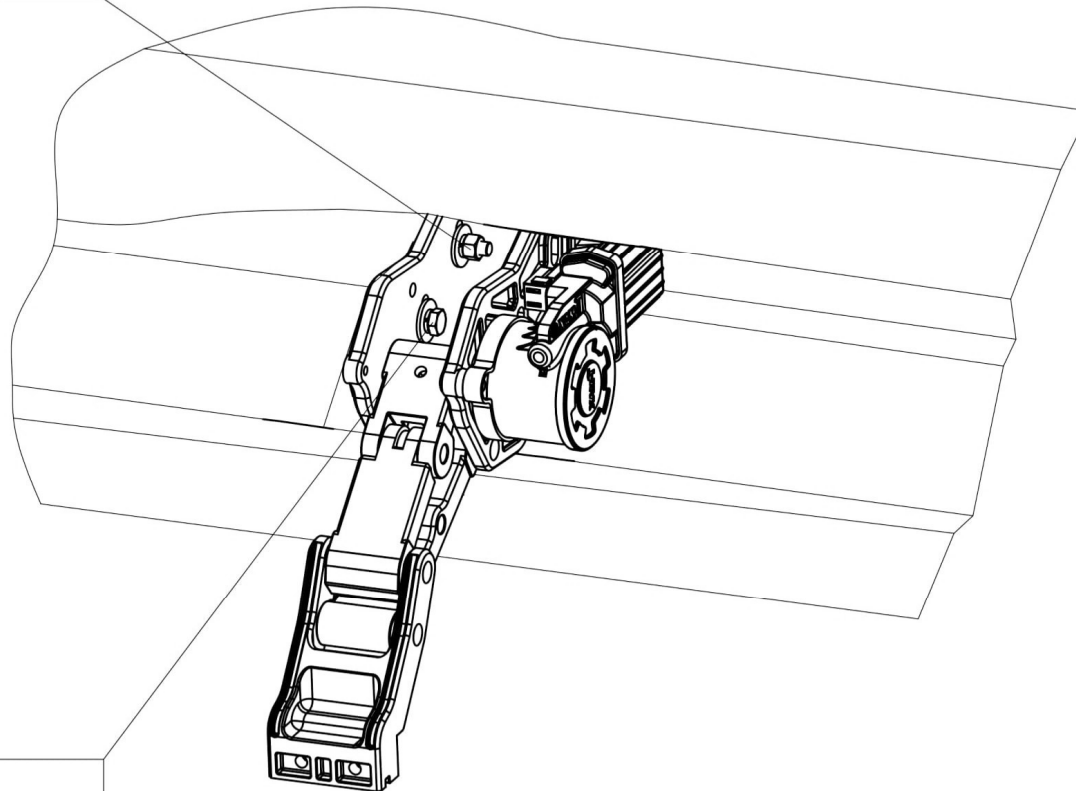

- ⑧ Φ8 Flat washer
- ⑦ Φ8 Spring washer
- ⑥ M8 Hexagon head bolt

Step 1: As shown in the picture, fixing the hexagon flange nut into the corresponding screw and pre-tighten it. Then fixing the hexagon head bolt (with spring washer and flat washer) into the corresponding installation hole and pre-tighten it. Tighten the above hexagon flange nut and hexagon head bolt.
(Tightening torque 30Nm)

On the rear of the left side

- ⑧ Φ8 Flat washer
- ⑦ Φ8 Spring washer
- ⑥ M8 Hexagon head bolt

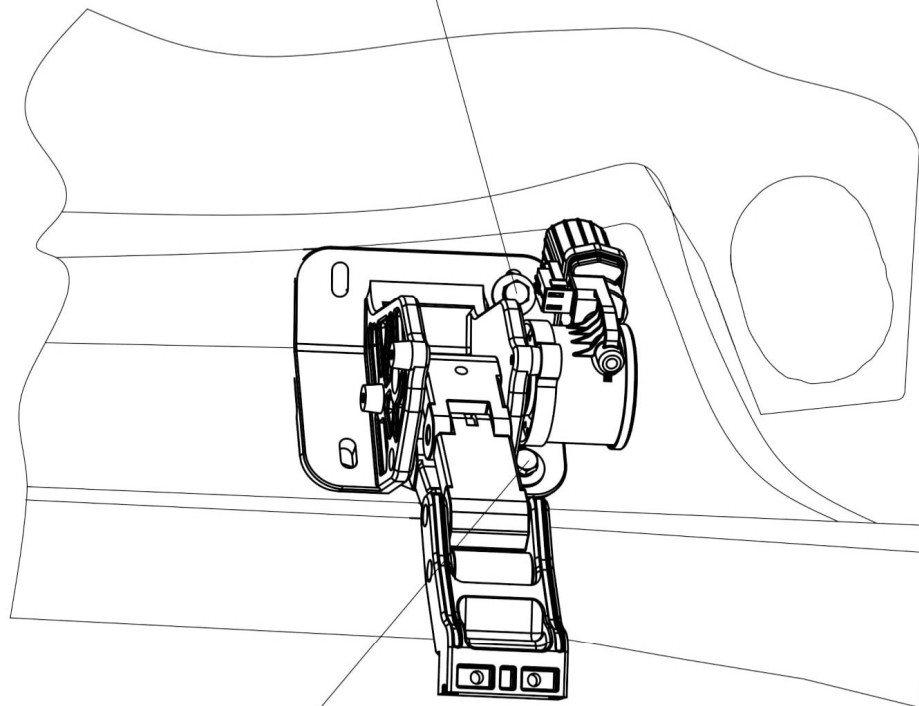

Step 2: As shown in the picture, fixing the hexagon flange nut into the corresponding screw and pre-tighten it. Then fixing the hexagon head bolt (with spring washer and flat washer) into the corresponding installation hole and pre-tighten it. Tighten the above hexagon flange nut and hexagon head bolt.
(Tightening torque 30Nm)

On the front of left side

- ⑧ Φ8 Flat washer
- ⑦ Φ8 Spring washer
- ⑥ M8 Hexagon head bolt

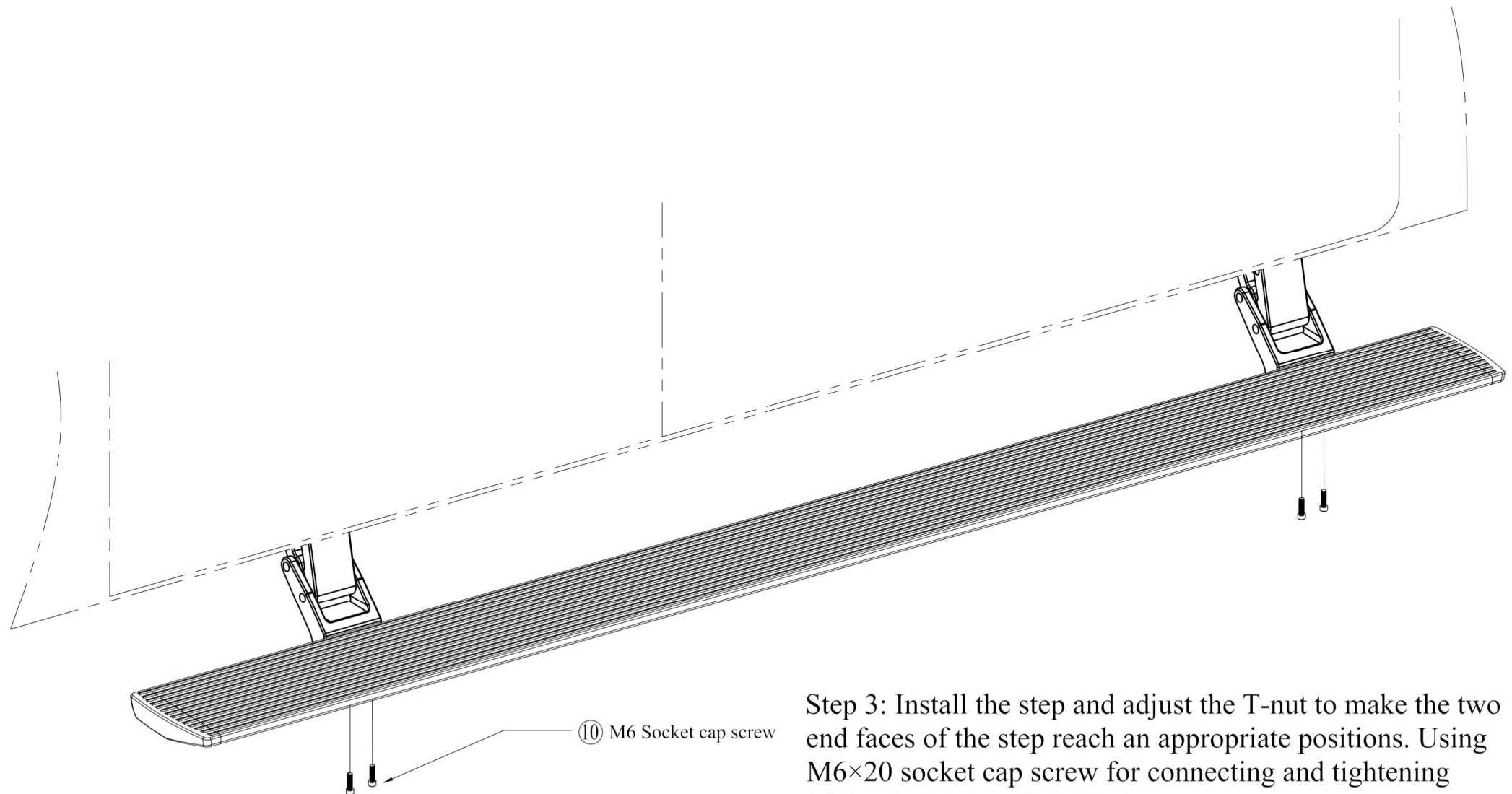

Step 3: Install the step and adjust the T-nut to make the two end faces of the step reach an appropriate positions. Using M6×20 socket cap screw for connecting and tightening (tightening torque is 14Nm).

TOYOTA HILUX REVO

E-BOARD®

Electric Installation of
Magnetic Control

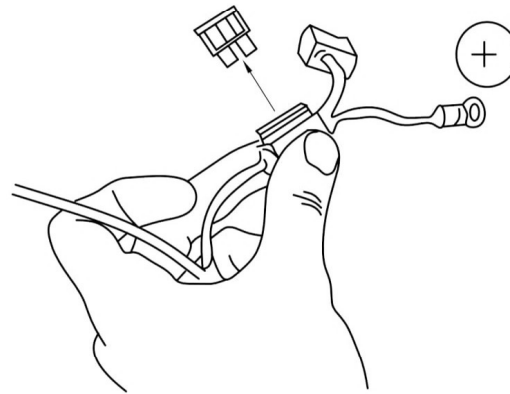
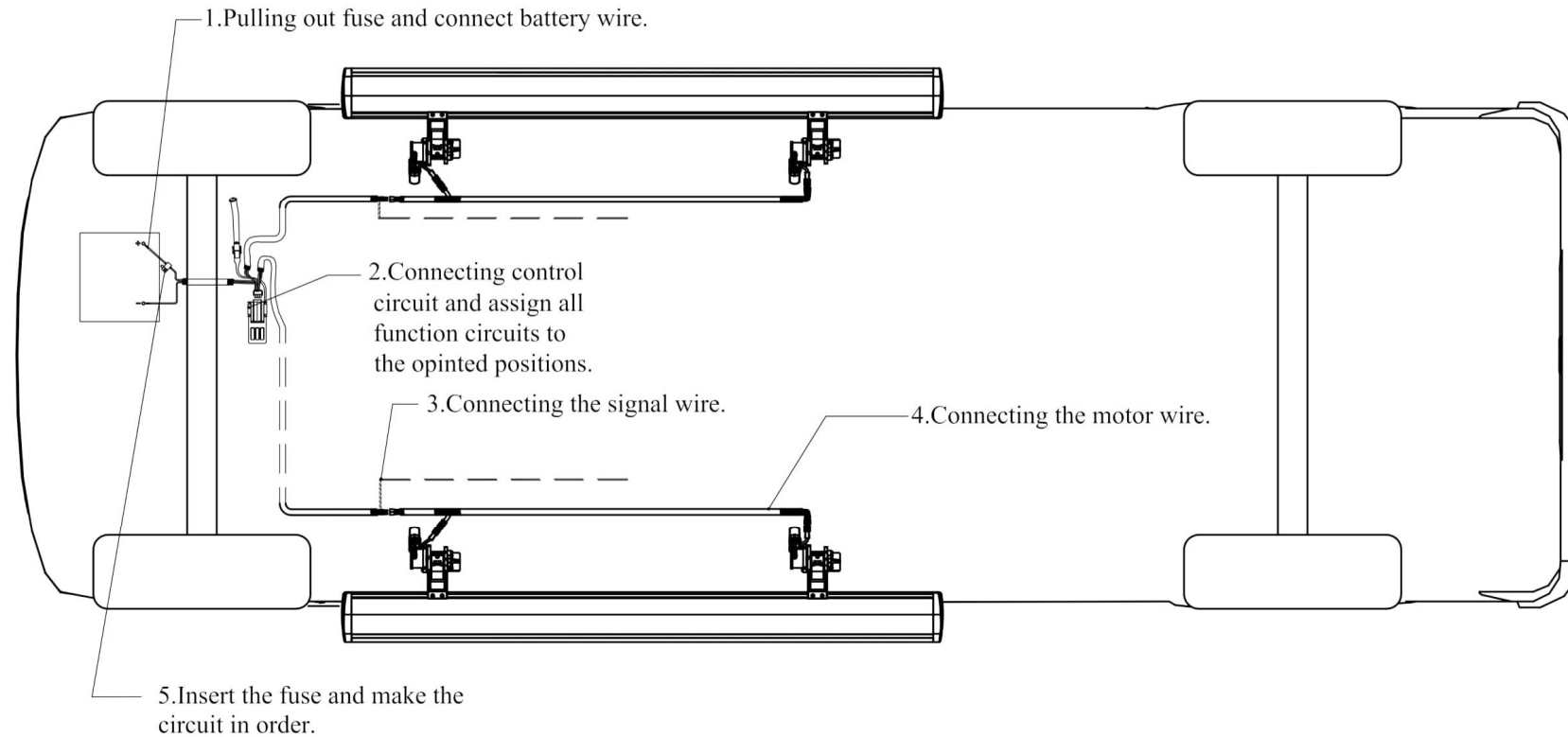

Step 4: Find ①6 control input wire, pull out the fuse (ensuring circuit safety during installation) and connect positive and negative to vehicle battery.

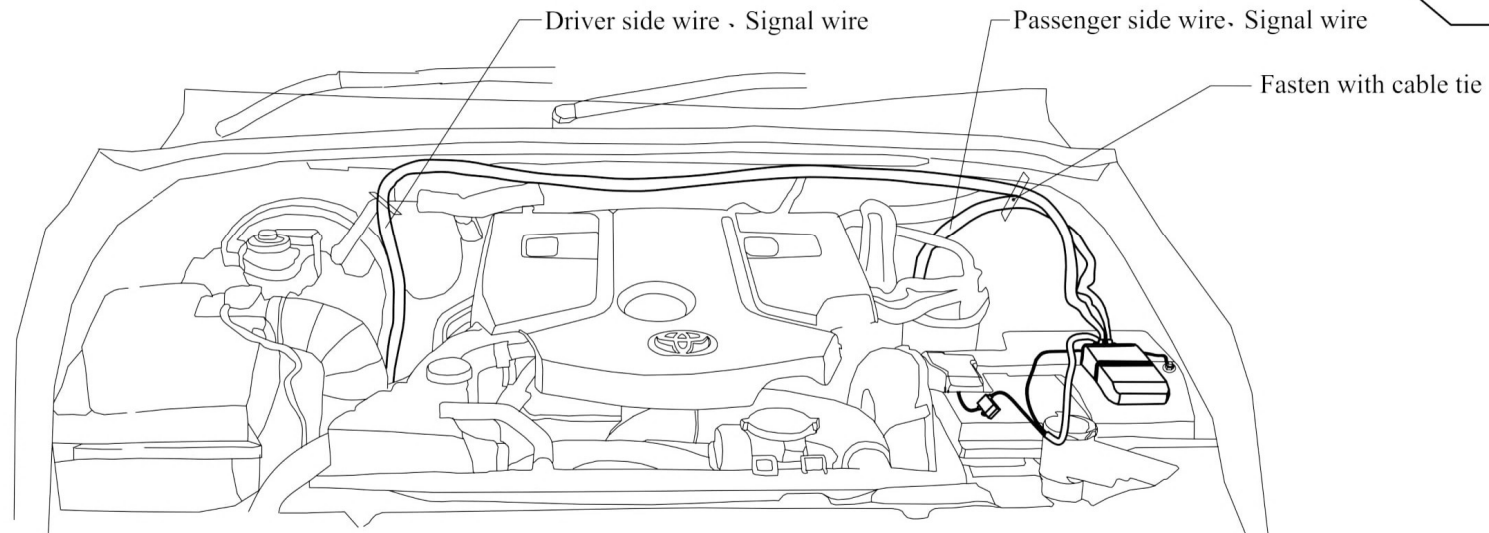

Step 5: As shown in the picture, fasten ⑮ controller assembly by cable tie, and fix up wire according to the wire label. Fixing wire by cable tie after all the wire go through the vehicle bottom, reaching vehicle bottom and inside.

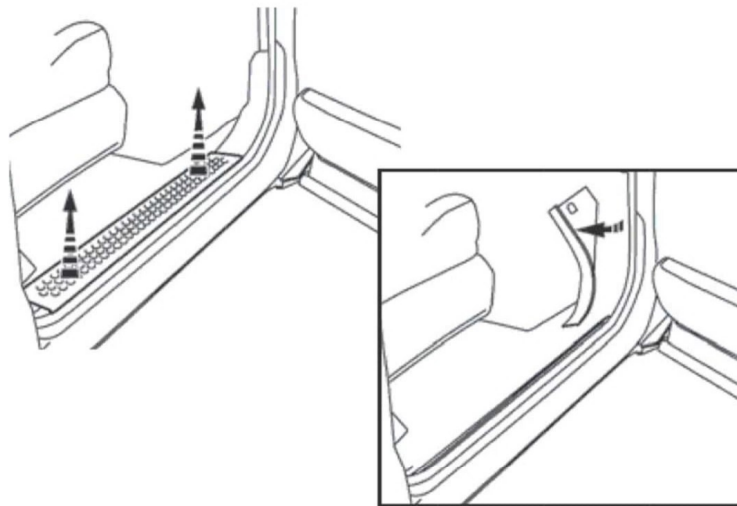

Step 6: Signal wire connection:
Pry the cover plate at the front passenger side as shown in the left picture, lift the foot cushion (right picture) and two signal wires of left and right doors have to pass through from the sealing rubber cover and get into the vehicle. (A hole should be bored in advance on the rubber cover.)

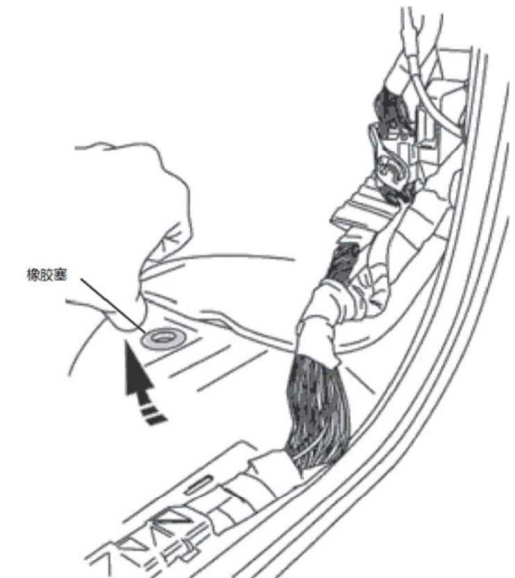

Introduction of magnetic inductor

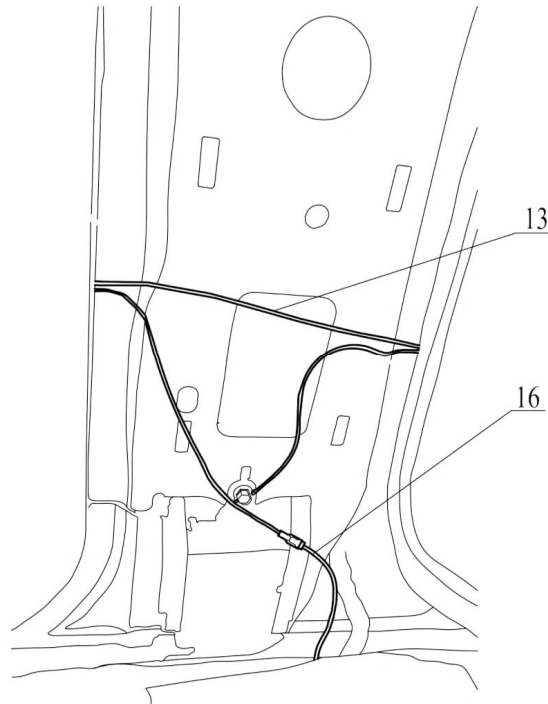

As shown in the above picture, connect signal wire of ⑬ control input wire with insulation connector A of ⑬ wire magnetic inductor, and connect terminal B with ground terminal of vehicle pillars.

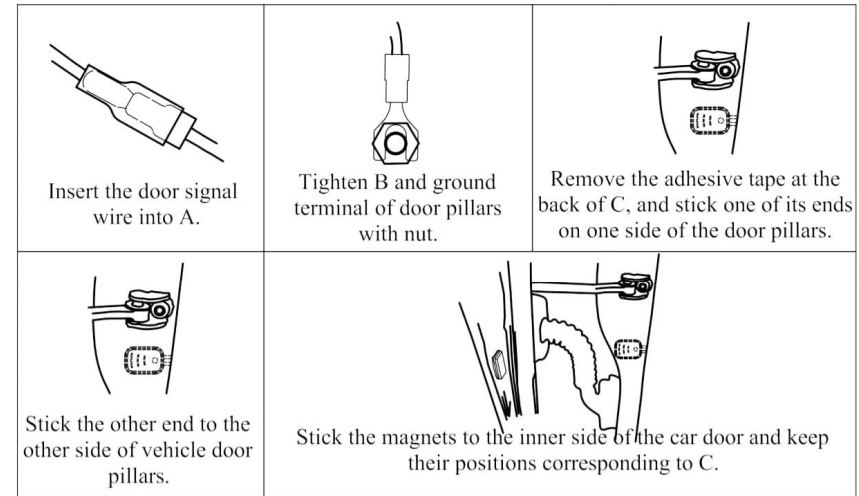
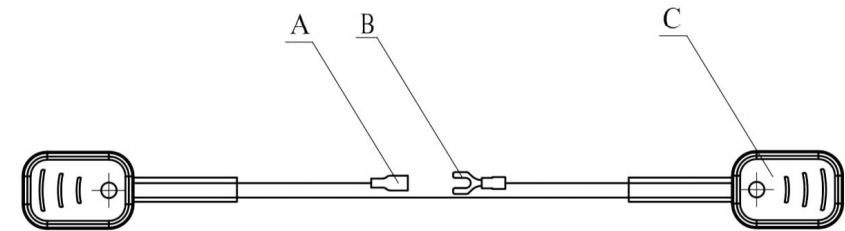

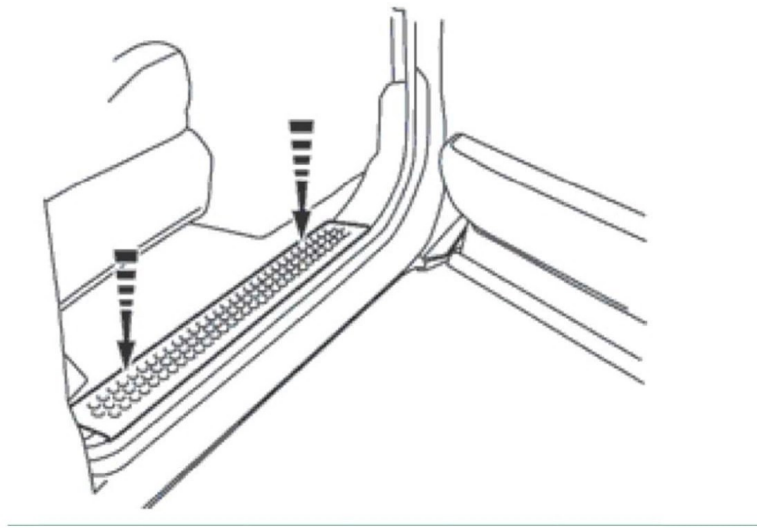

Step 7: Making the wire in order and close cover plate.

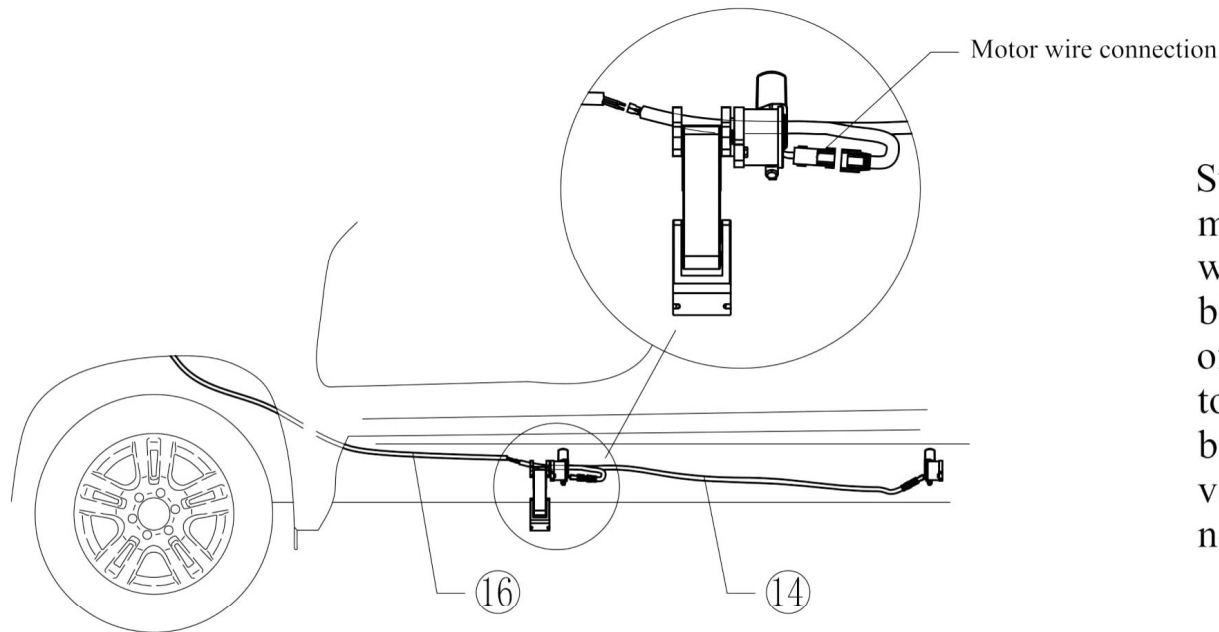

Step 8: Motor wire connection, connecting ⑭ motor connection wire with ⑮ control input wire and arrange the wire along the vehicle beam. Note that the connectors of conductors of the same color should be connected together. Same color motor connector should be connected together. Fasten the wire on the vehicle beam by cable tie to ensure the wire is neat. Same wire installation for the other side.

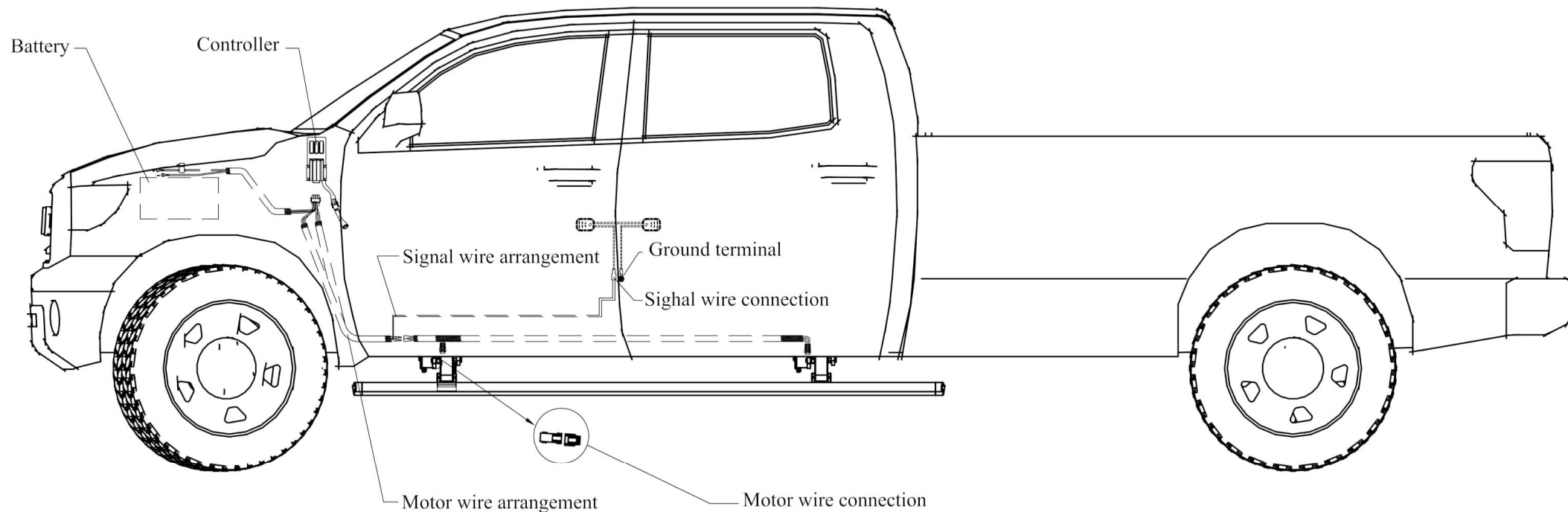

Step 9: Insert back the fuse, make the wire in order. Check if the circuits of all parts are installed completely and test if the step can work normally. If it can work normally, the step installation is completed. (If it cannot work normally, please check the installation of each part.)

Summary of electric part

Instructions of Emergency Switch

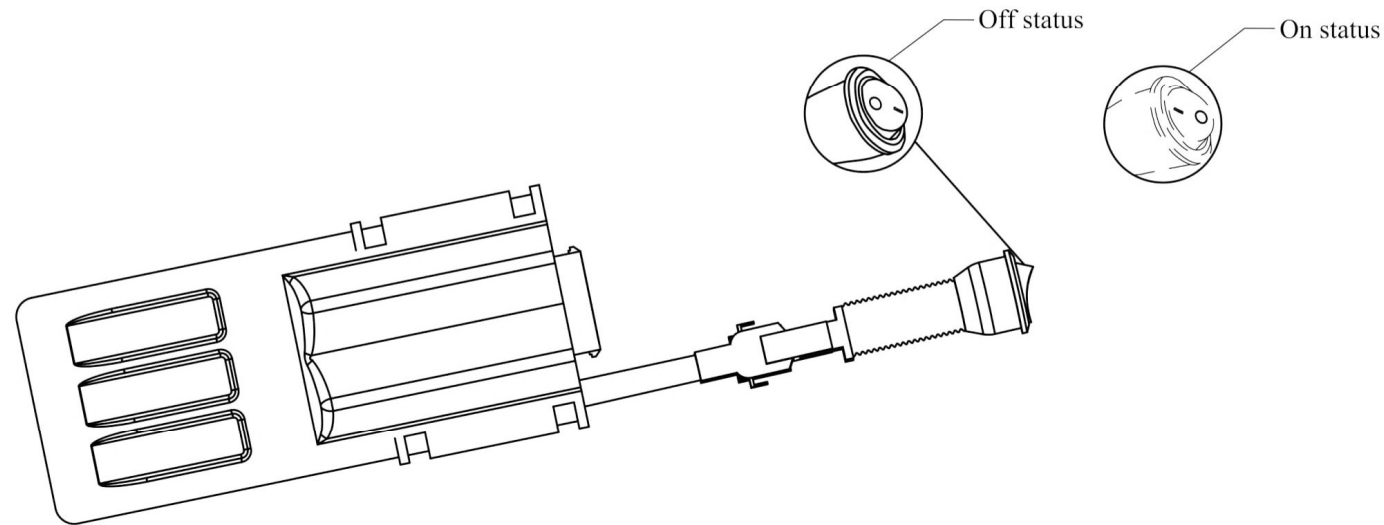

I. Function of emergency switch

Press the red switch button in case of any emergency or product failure to protect vehicle will not damage under these condition. Both steps will go back automatically while the emergency switch button is turned on.

II. The condition for using emergency switch:

1. Product failure;
2. User needs steps not work while the road / off-road situation is tough.
3. Please do not use power board if motor linkage or control wire is damaged.

III. Emergency switch using method:

1. Press emergency switch button, and the emergency switch is "on". And at the same time, the steps will automatically go back and stop working. In case of product failure, please contact with after-sales service.
2. Press the emergency switch button again, and the emergency switch is "off". And at the same time, the power board will return to its normal working status.
3. The original status of emergency switch is "off".

Maintenance		
3 months Periodical Inspection	Inspect the normal operation of the mechanism	
	Inspect damage for each joint of the control cable and the bare part outside of the girder	
	Inspect screws' looseness of motor and power board	
Special Case Inspection	Clean sediment on time for power board and its components	
	Clean ice on time for power board and its components	
Maintenance card		
The board couldn't activate when doors open and close	Electrical Malfunction	Fault of wiring the battery
		Fault of wiring door signal
		Fault of controller
		Fault of motor wiring
		Fault of motor
		Inspect the wiring according to the wiring layout when the door control signal failure occurs
	Mechanics Malfunction	An object is block the board
		Boards are not mounting symmetrical

Note: In the use process, you may meet some other unknown trouble. Please contact us timely to feedback the problems, we will solve it for you as soon as possible. Thank you!

E-BOARD[®]

jhp.com.au
new vehicle enhancements

jhp new vehicle
enhancements